



**PROTECTING YOUR PRODUCTS ...
... AN EASY GAME**



SEMI-AUTOMATIC WRAPPING MACHINE

SPINNY S300



EFFE 3 TI srl | GATTINARA (VC) ITALY | Tel. +39 0163 828911 | Fax +39 0163 828990
info@effe3ti.com | www.effe3ti.com



EFFE 3 TI srl | GATTINARA (VC) ITALY
Tel. +39 0163 828911 | Fax +39 0163 828990
info@effe3ti.com | www.effe3ti.com

EFFE 3 TI PRESENTS THE SEMI-AUTOMATIC WRAPPING MACHINE

SPINNY S300

THE USER FRIENDLY, AFFORDABLE, RELIABLE AND FULLY CUSTOMIZABLE MACHINE THAT WILL LET YOU REACH HIGH STANDARDS IN PACKAGING.



MAIN FEATURES

Spinny S300, with its 10 wrapping programs, is equipped with a motorized pre-stretch system that allows a sensible saving of film while wrapping.

The machine has 10 password protected programs and, on request, is also available with 5 pre-set programs.

- Pre-stretch up to 300%
- Pallet height detection with photocell
- Distance between column and turntable 500 mm
- Rotating table movement regulated by variable frequency drive
- Rotating table stop in position controlled by sensor
- Variable speed of film carriage completely customizable
- Working cycle controlled by PLC and electronic card

*Spinny S300 is extremely customizable and available with many optionals to fit all the customer's needs. Versions TP (hand pallet jack), PRESS (top press), DUO (double table), TOUCH (touch screen control panel), STAINLESS STEEL, DUAL MOTORS (with Dual Motor Pre-stretch system) or for DOORS & WINDOWS packaging are **only few** of the customizations available for SPINNY S300.*

PRE-STRETCH SYSTEM = ECONOMIC ADVANTAGE

All models of SPINNY S300 are equipped with an high-performance **MOTORIZED PRE-STRETCH SYSTEM**.

The power pre-stretch is a special device which allows the best utilization of the stretch film quantity; moreover, it permits to wrap light and unsteady pallets that couldn't be wrapped with different frictioning systems.

The stretch film is supplied in the right quantity by the rollers that are operated by a motor, which is controlled by an electronic system that measures the speed and keeps the film tension constant on the whole pallet's surface.

The motorized pre-stretch system, allows an efficiency of film up to **300%**.

FILM SAVING



SPINNY S300 DUAL MOTOR gives you even more!

The **DUAL MOTOR** version is designed to let you save even more film, obtaining more economic advantages.

Based on the same principle of the single motor version, with the **DUAL MOTOR** system, SPINNY S300 offers variable stretch factor up to **400%**!

FILM SAVING

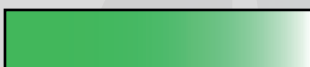

NEED A SPECIAL SPINNY S300 VERSION?

HERE ARE SOME EXAMPLE ... CALL US FOR MORE!



STAINLESS STEEL

Available with the standard or the horse-shoe turntable, the STAINLESS STEEL version gives you the opportunity of having all the advantages of SPINNY S300 even when working in wet or aggressive environment.



PRESS SYSTEM

Available with the standard or the horse-shoe turntable, the PRESS version is the perfect solution for wrapping unstable or special loads (i.e. doors and windows). Depending on your needs, the press unit can be motorized or pneumatic.



GALVANIZED

TOP PRESS

WITH ROLLS

DUO

SPINNY S300 TECHNICAL DATA

- The standard machine is designed to wrap palletted loads with stretch plastic film having the dimension up to 1200 mm (L) X 800 mm (W), with a load capacity of 1200 kg.
- The turntable is also available with a diameter of 1500 mm, 1650 mm, 1800 mm and 2200 mm with a load capacity of 2000 kg.
- The column can be furnished to wrap pallets with heights of 2100 mm, 2600 mm and 3100 mm.
- Table rotation speed and film carrier speed are regulated by inverter (turntable can rotate at a speed from 5 to 10 RPM).

ELECTRICAL SUPPLY

- Tension: 230 V single phase or, on demand, 400-415 V triple phase $\pm 10\%$
- Frequency: 50 Hz
- Installed power: 1,3 kW
- Auxiliary energy supply: 24 V DC

FILM (LLDPE) AND COIL CHARACTERISTICS

- Thickness: 15 ÷ 40 μm
- Advised thickness: 23 μm
- Internal coil diameter: 76 mm
- Height: 500 mm
- Maximum film roll weight: 16 kg
- Maximum external coil diameter: 250 mm

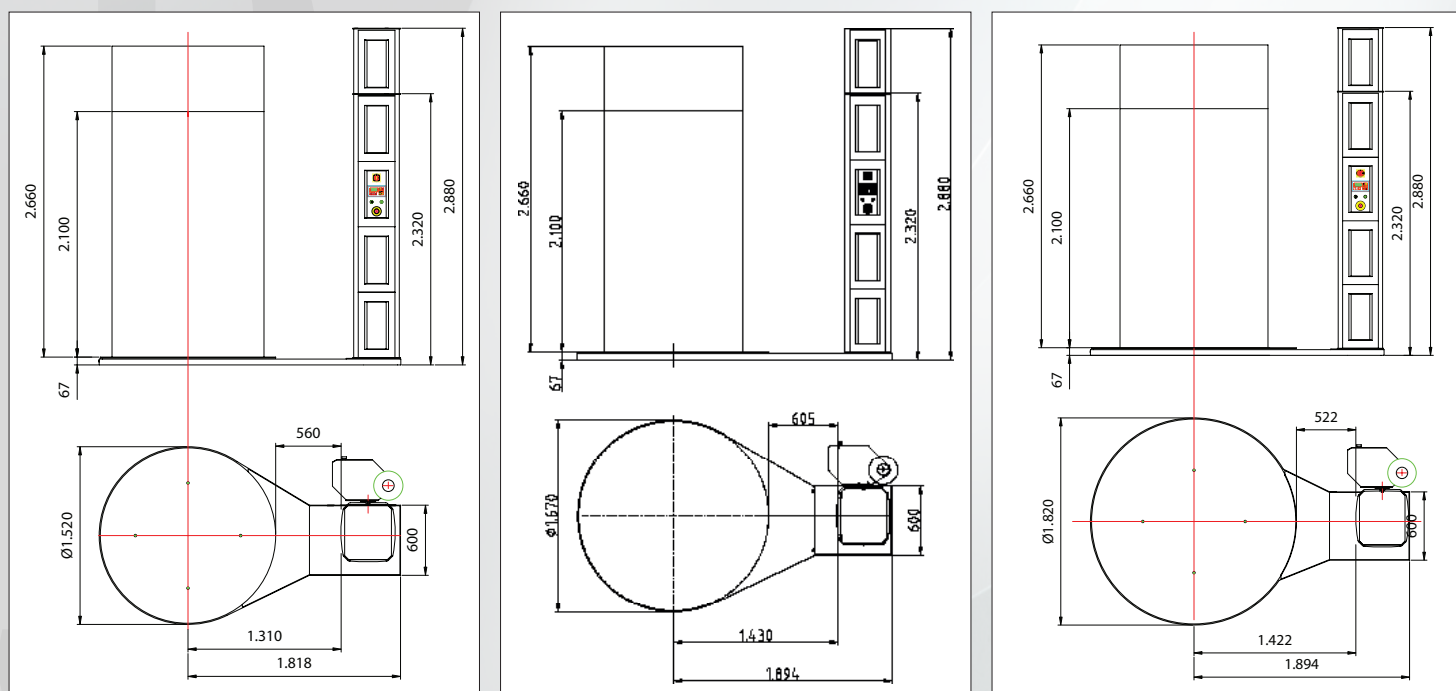

You Tube



www.effe3ti.com

www.youtube.com/effe3ti

www.reggiatrici-transpak.it

www.facebook.com/effe3ti

